

Models

System	HSNRQ25B	HSNRQ35B	HSNRQ50B	HSNRQ70B	HSNRQ80B
Indoor	HINRQ25B	HINRQ35B	HINRQ50B	HINRQ70B	HINRQ80B
Outdoor	HONRQ25B	HONRQ35B	HONRQ50B	HONRQ70B	HONRQ80B

REFRIGERANT
R32

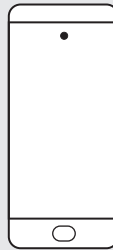
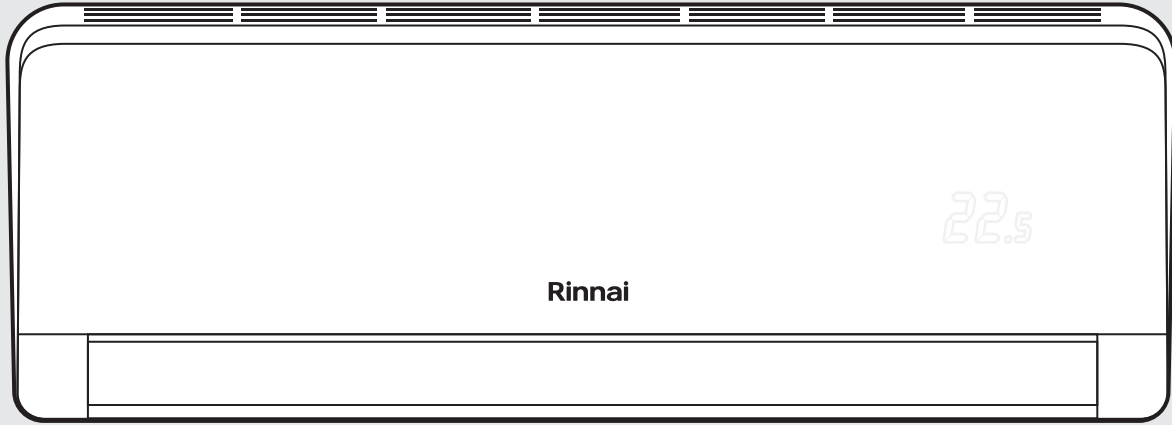

Q Series Split Type Wall Mounted Air Conditioner

Wi-Fi Operation Manual

Rinnai

This appliance must be installed in accordance with:

- Manufacturer's Installation Instructions
- Current AS/NZS 3000, AS/NZS 5141
- Local Regulations and Municipal Building Codes including local OH&S requirements

This appliance must be installed, maintained and removed only by an Authorised Person.

For continued safety of this appliance it must be installed and maintained in accordance with the manufacturer's instructions.



TABLE OF CONTENTS

Terms & Conditions	4
Introduction	5
Wi-Fi Compatibility / Connectivity	5
Minimum Requirements	5
Wi-Fi Set Up	6
Device Editor	9
Operation	10
Display	10
Mildew (Fresh)	11
Clean Button	11
Mode Button	11
Cooling	11
Heating	11
Fan	11
Dry (Dehumidifying)	12
Auto	12
Fan Speed Button	12
Sleep Curve	14
App Settings	15
Temperature Ambient	15
Scan QR code	15
Account	15
Device Sharing	15
Help	15
Software Version	15
Contacts	16

TERMS & CONDITIONS

1. DEFINITIONS

App means the AC Freedom App you can download to your Device to operate your Rinnai Q Series.

Australian Consumer Law ('ACL') is Schedule 2 of the Competition and Consumer Act 2010.

Device means your smart phone/ tablet (Android. 4.1+ or Apple iOS9.0+) through which you have downloaded the App.

Rinnai Q Series means a Q Series Inverter Split System, comprising the following models:

Q Series Models	HSNRQ25B	HSNRQ35B	HSNRQ50B	HSNRQ70B	HSNRQ80B
------------------------	-----------------	-----------------	-----------------	-----------------	-----------------

Rinnai, we, our or us means Rinnai Australia Pty Ltd (ABN 74 005 138 769).

WiFi Operations Manual means the WiFi operations manual which details how to download and operate the App.

you or your means a customer who uses the Rinnai Q Series and App.

2. GENERAL

- 2.1 By downloading the App, you agree to be bound by these Terms & Conditions.
- 2.2 These Terms & Conditions should be read in conjunction with the WiFi Operations Manual.
- 2.3 Rinnai may make updates to these Terms & Conditions from time to time. You should download and understand all relevant updates to ensure you understand your obligations and Rinnai's obligations under the Terms & Conditions.
- 2.4 Rinnai may make updates to the App from time to time. You should download and understand all relevant updates to ensure you have access to the functions of your Rinnai Q Series and App.

3. THE AUSTRALIAN CONSUMER LAW ('ACL')

Our goods come with guarantees that cannot be excluded under the ACL. You are entitled to a replacement or refund for a major failure and compensation for any other reasonably foreseeable loss or damage. You are also entitled to have the goods repaired or replaced if the goods fail to be of acceptable quality and the failure does not amount to a major failure.

All the clauses under these Terms & Conditions apply subject to the ACL.

4. USE OF THE APP

- 4.1 You may download the App to your Device for your personal use only.
- 4.2 You are responsible for all costs incurred in accessing, downloading and using the App. This includes but is not limited to fees charged by your internet service provider, smartphone or app data access charges and any other access charges or device usage charges.
- 4.3 You must follow the instructions in the WiFi Operations Manual to operate the Rinnai Q Series via the App.
- 4.4 You must not use the App for any prohibited or unlawful purpose.
- 4.5 The App is available as another means to control and monitor the Rinnai Q Series, but should not be used for critical heating or cooling applications.

5. TERMINATION

- 5.1 You may terminate these Terms & Conditions by deleting and ceasing use of the App.
- 5.2 Rinnai may terminate these Terms & Conditions immediately through the App or by any other appropriate means if you are in breach of the Terms & Conditions.

6. INTELLECTUAL PROPERTY

- 6.1 If you download the App, Rinnai grants you a limited, non-exclusive, non-transferable, and non-assignable royalty free licence solely in order to access and use the App.
- 6.2 All intellectual property rights in the Rinnai Q Series and the App are owned by Rinnai or licensed to Rinnai by third parties. You do not acquire any express or implied rights in any these intellectual property rights, other than those granted in clause 6.1 and within the context of these Terms & Conditions.
- 6.3 You may not modify, copy, sell, reproduce, interfere with or distribute the App in any way.

7. DISCLAIMER

To the extent permitted by law:

- 7.1 Rinnai makes no warranties that the App will be error-free, secure or free from any virus, malicious code or other adverse elements. Rinnai therefore excludes any liability which may arise as a result of you downloading, accessing or using the App. Rinnai does not exclude or restrict liability to the extent provided for by the ACL under the Competition and Consumer Act 2010.
- 7.2 Rinnai will not be liable for any indirect, incidental, special or consequential loss.

8. FORCE MAJEURE

Unless prohibited by law, Rinnai shall be released from its obligations in the event of national emergency, war, prohibitive governmental regulation, or if any other cause beyond the control of the parties renders the App or Rinnai Q Series inoperable.

Wi-Fi COMPATIBILITY / CONNECTIVITY

Rinnai Split Type Wall Mounted Air Conditioner models HSNRQ25B, HSNRQ35B, HSNRQ50B, HSNRQ70B and HSNRQ80B are fitted with built-in Wi-Fi connectivity. Using the AC Freedom App (available from Apple App Store or Google Play) it is then possible to use a smart phone to operate these appliances remotely. Multiple compatible appliances can be added as required.

A Wi-Fi router (paired with the appliance via AC Freedom App) is used to control the Air Conditioner(s).

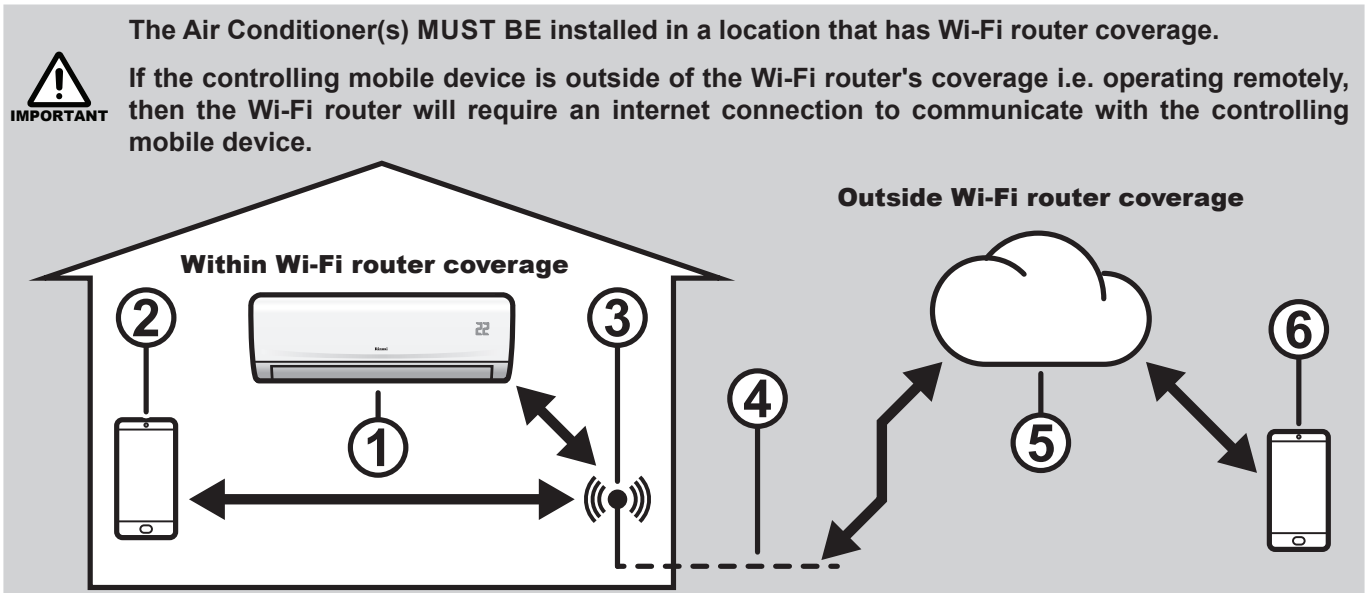

1. Indoor air conditioning unit (AC Device)
2. Smart phone or tablet (using Wi-Fi)
3. Wi-Fi router
4. Internet connection
5. Internet cloud
6. Smart phone (using internet cloud)

MINIMUM REQUIREMENTS

- Rinnai Split Type Wall Mounted Air Conditioner models: HSNRQ25B, HSNRQ35B, HSNRQ50B, HSNRQ70B and HSNRQ80B
- Wi-Fi Router, 2.4G frequency range supporting 802.11b/g/n mode, with coverage of the Appliance(s) location
- For remote cloud based operation Wi-Fi router / modem with active internet connection
- Smart phone / Tablet (Android 4.1+ or Apple iOS 9.0+) with AC Freedom App installed



Android QR code

or search AC Freedom in Google Play



iOS QR code

or search AC Freedom in Apple App Store

WI-FI SET UP

Pairing With Mobile device & Wi-Fi Network

1. Open App, then read and confirm the Privacy Notice

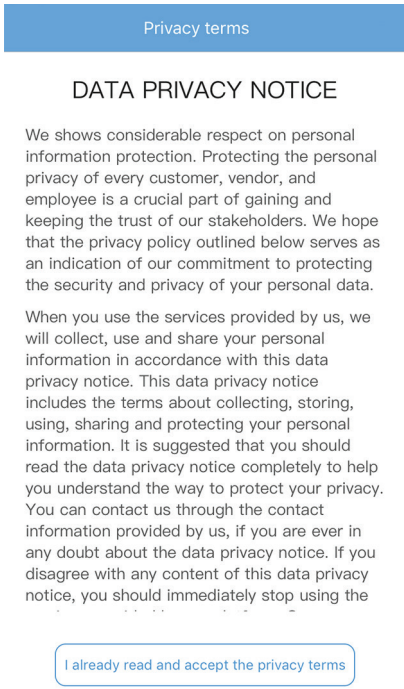

2. For AU, select 'other areas'. If unsuccessful, you can select European region. Select OK.

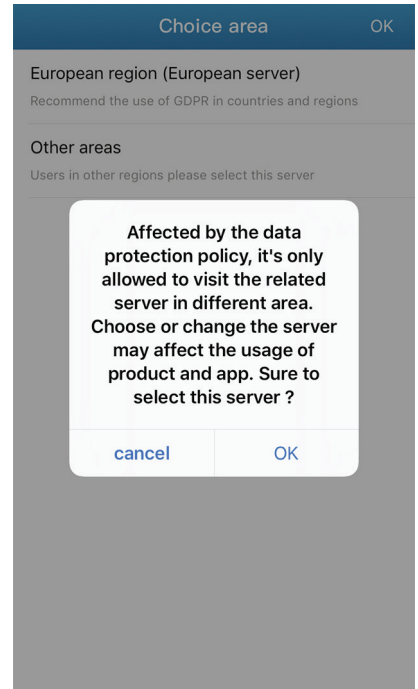
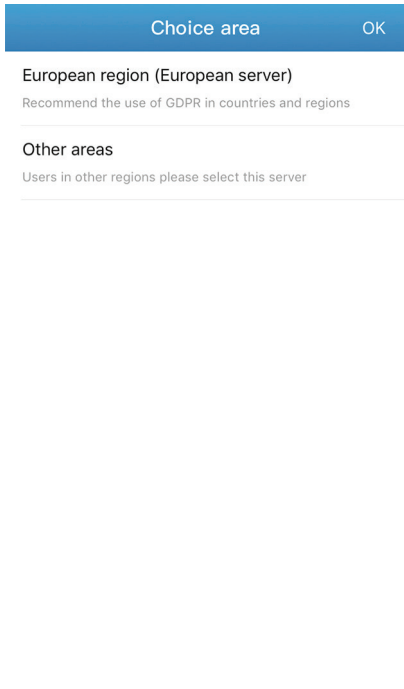

3. Before the AC Freedom App can be used it will need to be activated, by either a **QR code** or by an **Activation code**

QR code method - Select **scan** and use the mobile device's camera to capture the QR code below

Activation code method - Type **rinnai** into the **enter activation code** field and select **activate**.

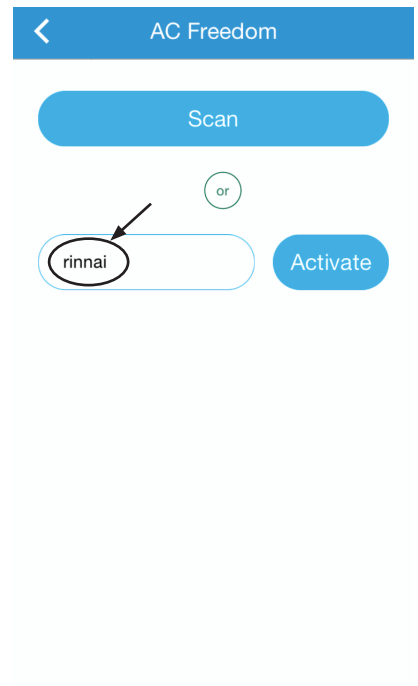
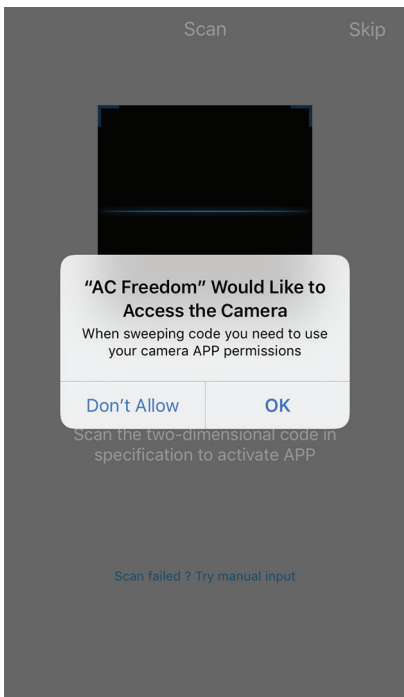

Note: If prompted, give the App permission to use the mobile device's camera.

The activation code is case sensitive (all lower case)

4. A **Rinnai** welcome page is displayed briefly to confirm a successful activation.



5. Enter user name and password to log into App. If you don't have a login, select 'Sign up'. Use phone number or email address with a unique password.

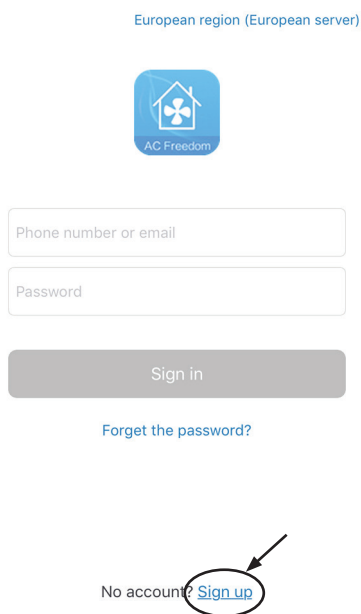

6. Check your email or mobile text messages for verification code. Enter code to complete registration.

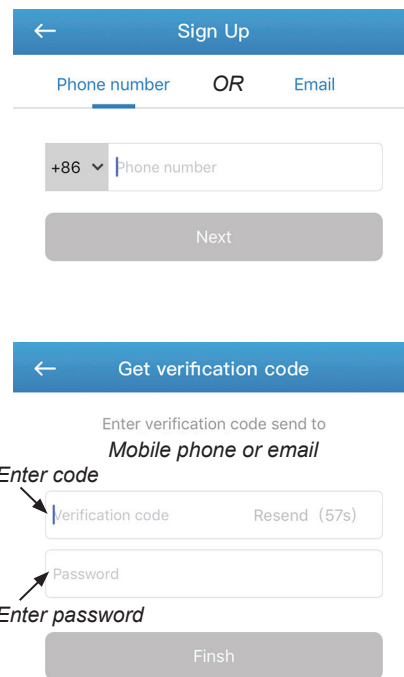

Password requires a minimum of 8 characters including alphabet and numerals.

7. Select the + **Add device** button, on the Device List page. Follow prompts on the screen. Turn on the Air Conditioner that is to be paired, then activate the Wi-Fi module by pressing the **HEALTH** button on the remote control 8 times.

A double beep confirms Wi-Fi module is activated and will be available to pair for 30 minutes.

Select Next Step

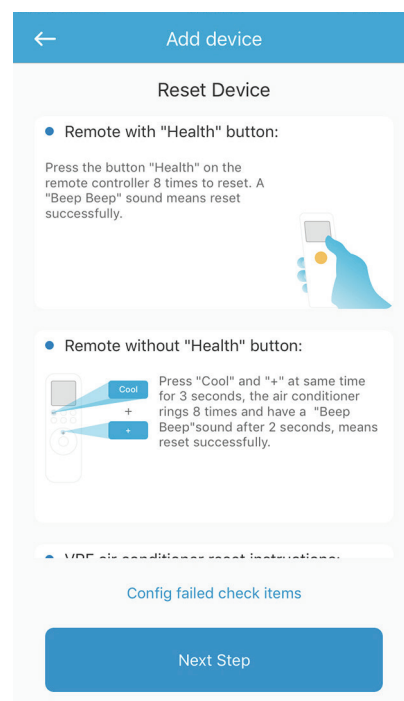
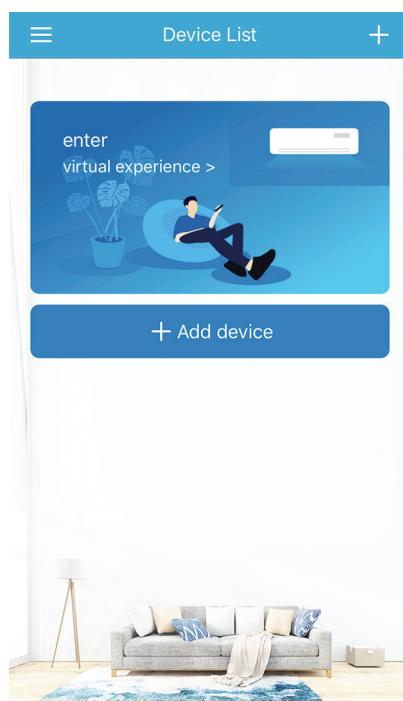

Changing your internet provider/service may mean you need to uninstall the App and register again.

8. Connect to desired Wi-Fi network to begin configuration.

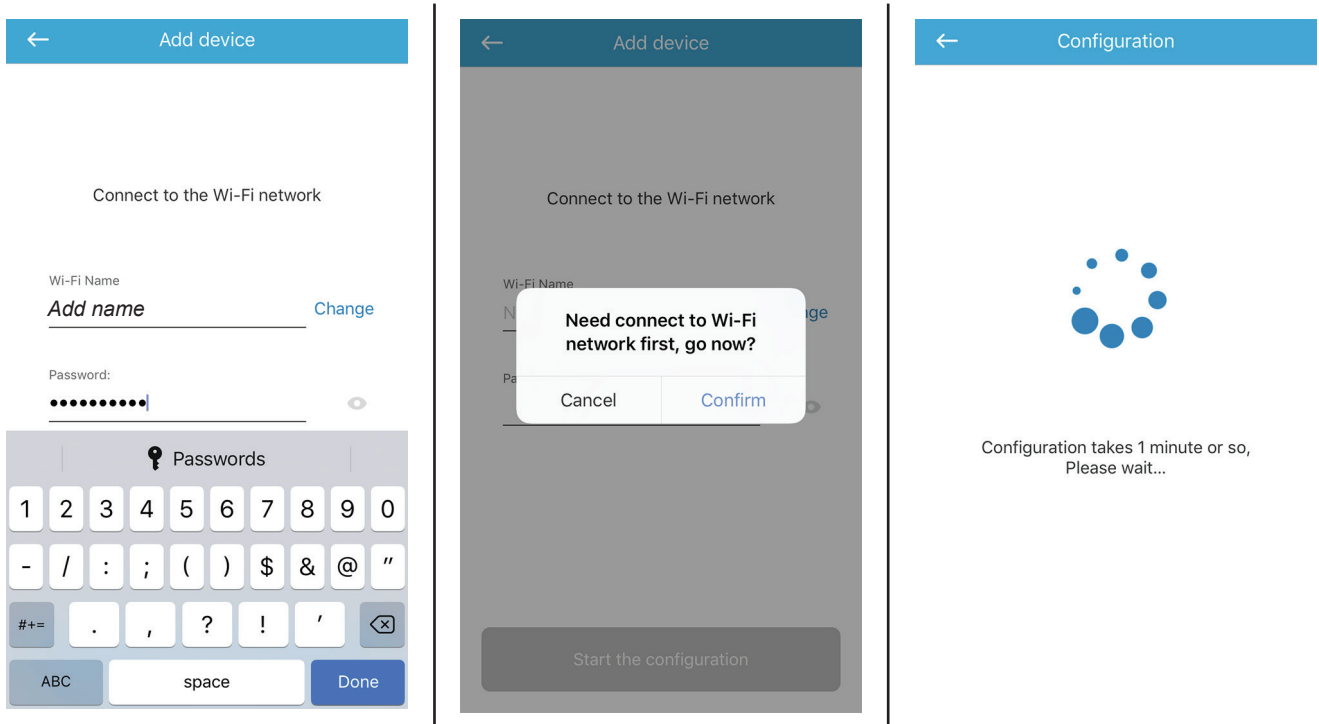

The configuration process may take up to a minute or more depending upon signal strength. The Device List page will be displayed with the new AC device listed when configuration is complete. To add additional AC devices to the current mobile device press the + 'Add button' and follow the screen prompts.

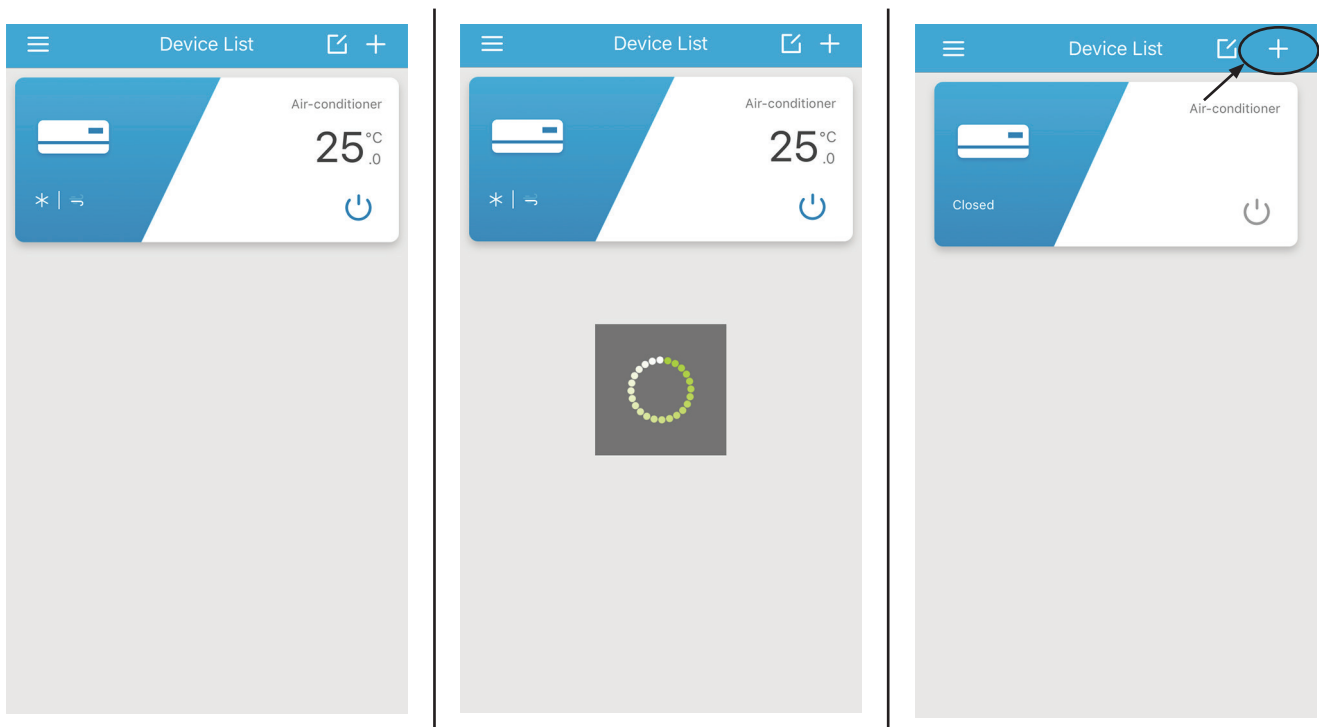

**If the configuration is unsuccessful, confirm that Wi-Fi network is still up. If the Wi-Fi network is working correctly then repeat configuration steps.
If configuration continues to fail contact Rinnai.**

DEVICE EDITOR

Device Editor allows customising of the App to AC device interface and access to AC device firmware updates.



The AC device to be edited **MUST BE** on and connected to the Wi-Fi Network.
Before exiting the Device Editor, **Save** changes, as all unsaved changes will be **LOST**.
Locking only restricts the ability to pair any additional mobile devices to an AC device.

To enter the **Device Editor**, at the Device List page press on the **Icon** ≡ to the left of the desired device's name for 3 seconds.



To change the AC devices icon for a specific mobile device, select **Photo** icon, and follow the on screen prompts to choose a new image.

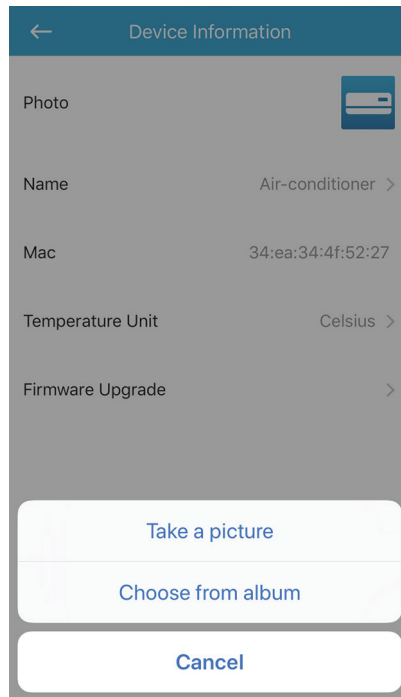

To change the AC devices name for all mobile devices, select the **Name** text field and type a new name (e.g. Bedroom, Upstairs, etc).

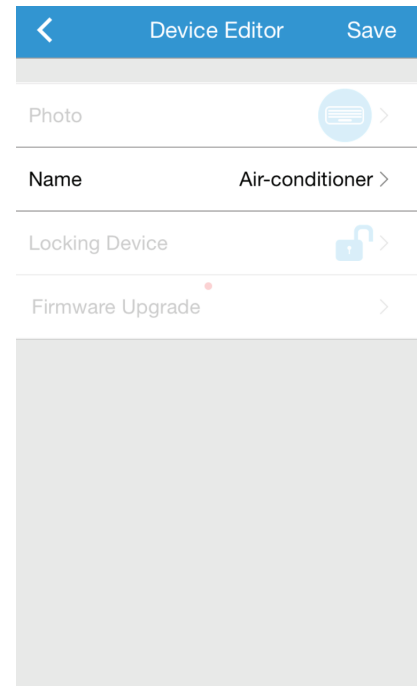

To restrict mobile device access select the **padlock** icon, blue / open is unlocked, red / closed is locked.

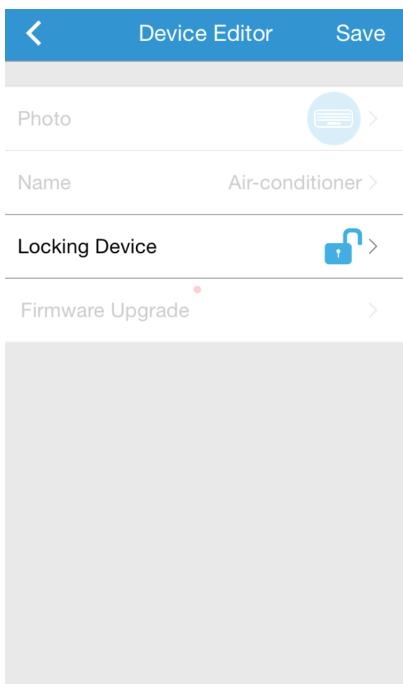

To update firmware, select **Firmware Upgrade**, if local and server versions are different select **Upgrade**, once updated both versions will be the same. The Wi-Fi router **MUST** have an internet connection for firmware updates.

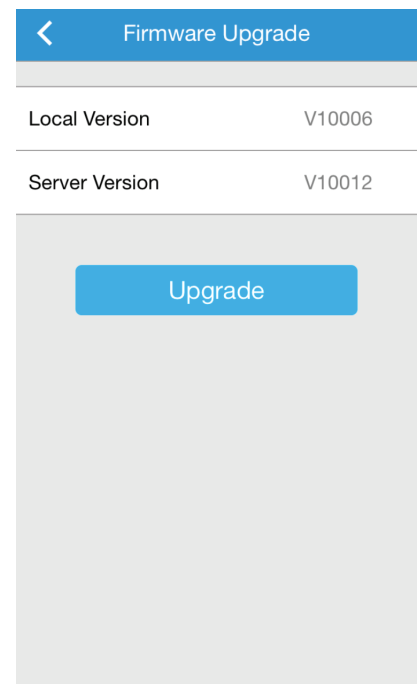
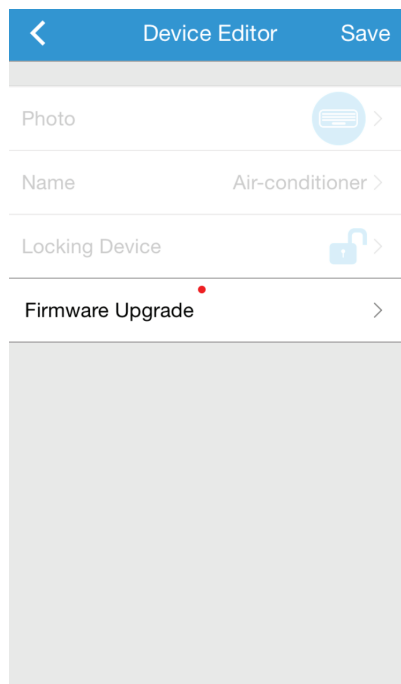

OPERATION

DEVICE LIST PAGE

After opening the App the Device List page is displayed, select the desired AC device that you wish to control.

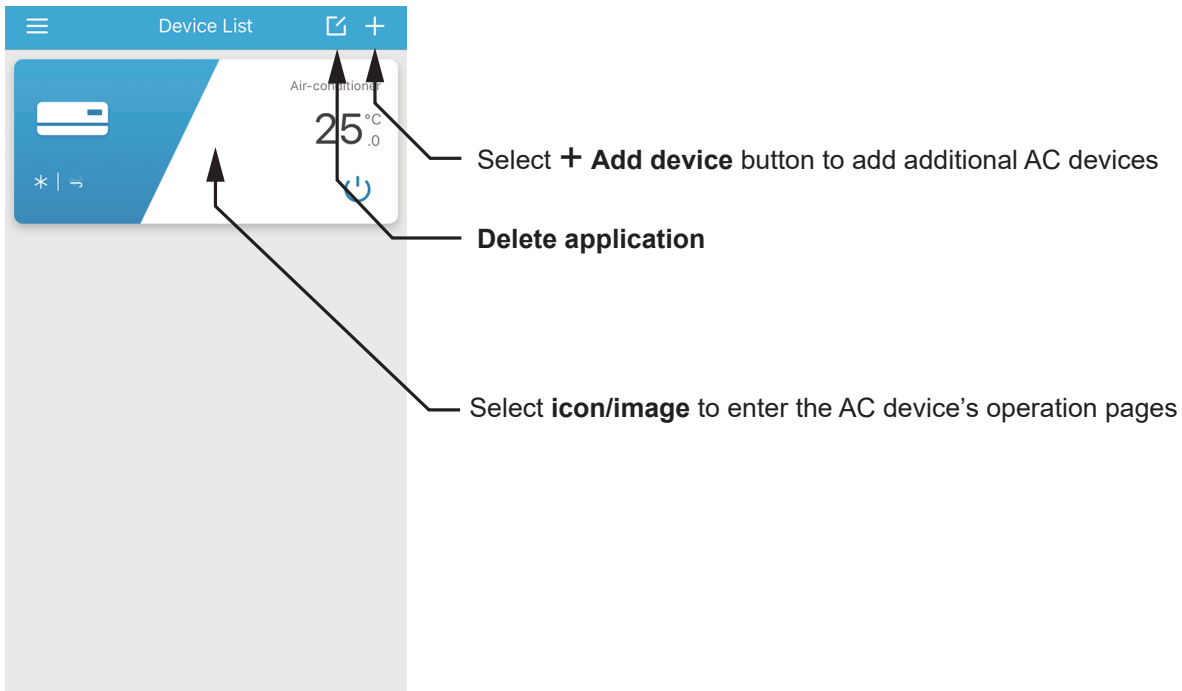

STANDBY MODE PAGE

Air Conditioner is plugged in with the power turned on, but is not in an operational mode.

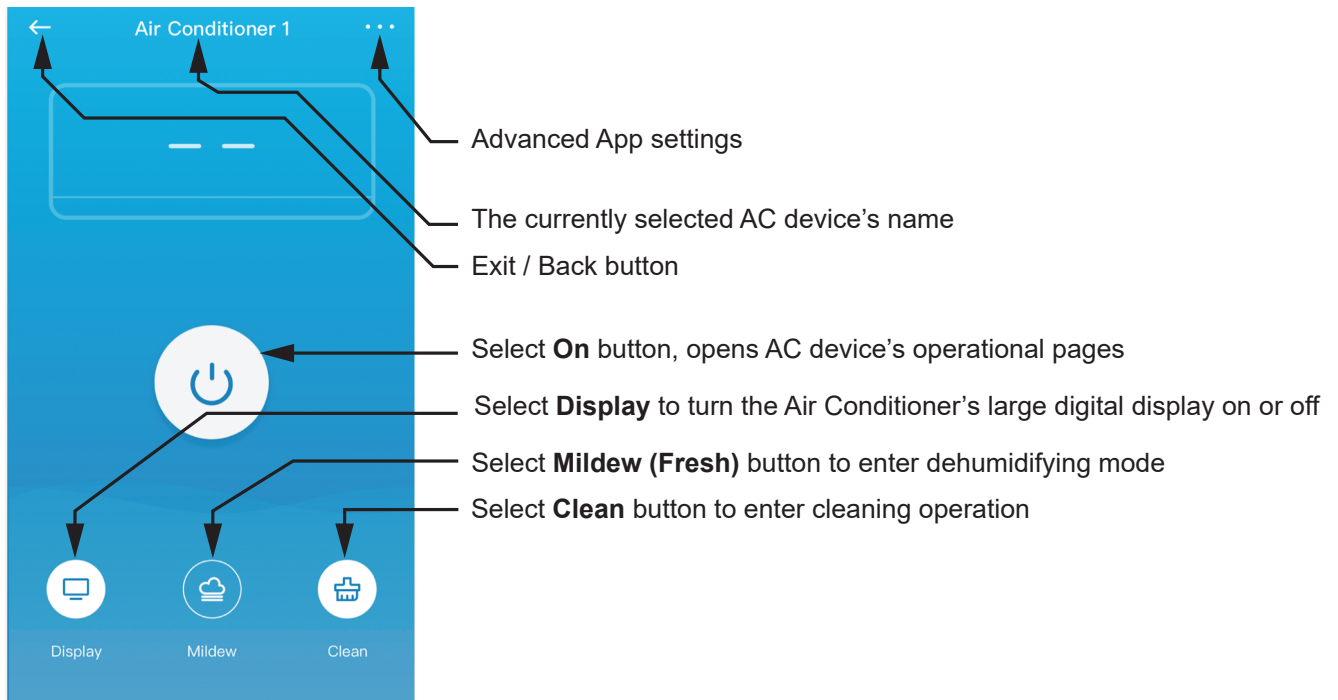

DISPLAY

Turns the large digital display that is built into the appliance and illuminates through the front cover of the indoor unit on or off.



MILDEW (FRESH)

Cooling and dehumidifying operations can generate moisture inside the appliance. Using the "FRESH" function removes such moisture by allowing the fan to run for 3 minutes after every shut-down, avoiding odours and keeping the unit fresh. Select the **Mildew** button to enable the Fresh operational mode.

CLEAN BUTTON

Cooling and dehumidifying operations can generate moisture inside the appliance. If the appliance is not going to be used for a long period (in excess of one month), it is suggested to run the cleaning operation to remove dust and moisture and avoid odours before leaving. Select the **Clean** button to start the cleaning operation.



This cleaning operation takes approximately 35mins and the appliance automatically shuts off at completion of the cleaning cycle.

OPERATION FUNCTIONS

When on this screen, all operational controls (Heating, Cooling, Fan Speed, Set Timer, etc) can be accessed.

← Select **On/Off** button, to place the AC device in Standby mode
 Air Conditioner 1
 Temperature Ambient 30°C
 The currently selected AC device's name
 Current room temperature
 Adjust **Temp** up or down
 25 °C
 Set temperature
 Cooling Low
 Current operational mode
 (exit / back) button
 Mode * Select **Mode** button, to choose a basic operation mode
 Fan Speed ⇄ Fan Speed (Mute, Low, Mid, High, Turbo, Auto)
 Fixation ↕ Airflow operation to alter circulation

Select a basic operation mode or tap on the blank area to exit tab

MODE
 Cooling Heating Fan Dry
 Auto

MODE BUTTON

This opens the basic operation mode selection tab.

COOLING

When selected this mode operates the Air Conditioner as a cooling appliance (the available temperature range is 16°C ~ 32°C in 0.5°C increments).

HEATING

When selected this mode operates the Air Conditioner as a heating appliance (the available temperature range is 16°C ~ 32°C in 0.5°C increments).

FAN

This mode uses the fan to circulate room air without changing the room temperature.

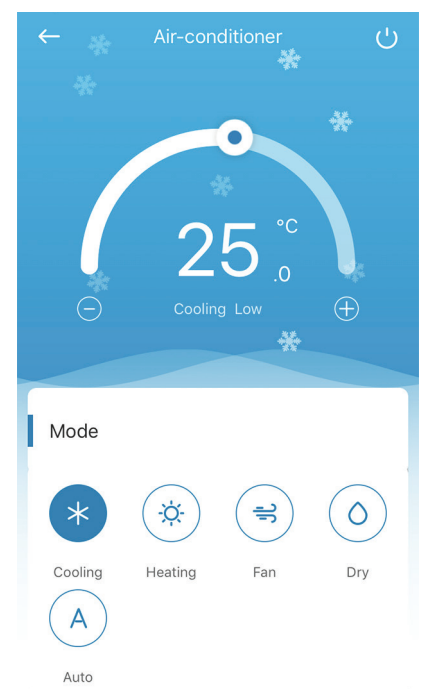

OPERATION

DRY (DEHUMIDIFYING)

In periods of high humidity this mode removes excess moisture from the room, in order to prevent mould and mildew and increase comfort.

This mode adjusts the room temperature and the fan speed automatically to maintain the optimal level of humidity.

AUTO

In this mode, the fan speed, heating or cooling mode and the temperature are all adjusted automatically by the appliance, based on the current room temperature.

The table below describes the relationship between room temperature and modes of operation when set to Auto.

Room Temperature	Set Temperature	Operation Mode
$\geq 27^{\circ}\text{C}$	24°C	Cooling Mode
$20^{\circ}\text{C} \sim 27^{\circ}\text{C}$	24°C	Dry Mode
$\leq 20^{\circ}\text{C}$	24°C	Heating Mode

FAN SPEED BUTTON

The fan speed can be adjusted manually or set to automatic. The available fan speeds are Mute, Low, Mid, High or Turbo. Select "Auto" if you wish the fan speed to be adjusted automatically by the appliance.



Only one mode of operation is available for use at any one time.

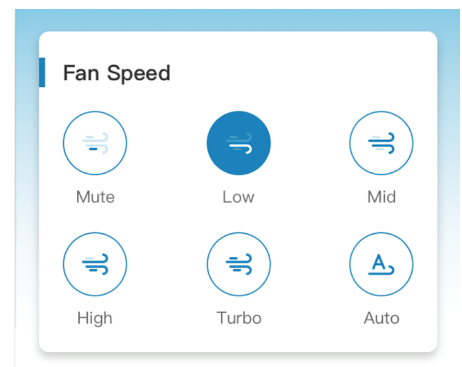

Scroll down screen for more functions

Display – to turn the air conditioner's large digital display On or Off

Health – currently has no function for the listed Air Conditioner models

Sleep – select to run the air conditioner in sleep mode

ECO – select to achieve the most economical cooling of the room

Timer – select to program On and Off timers

Sleep Curve – allows user to create customised sleep curve

Device Information – shows paired device information

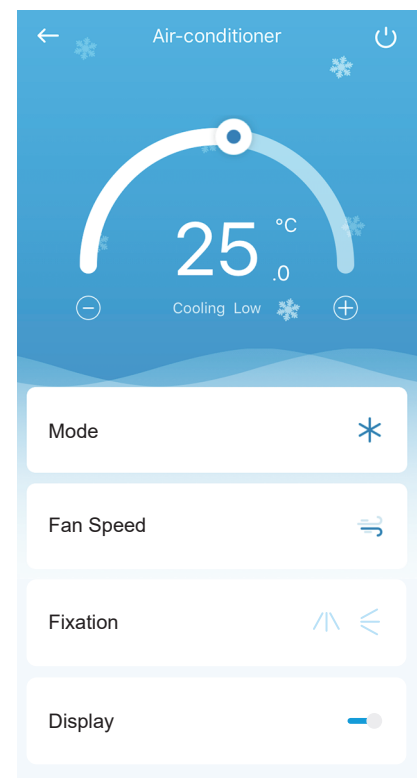
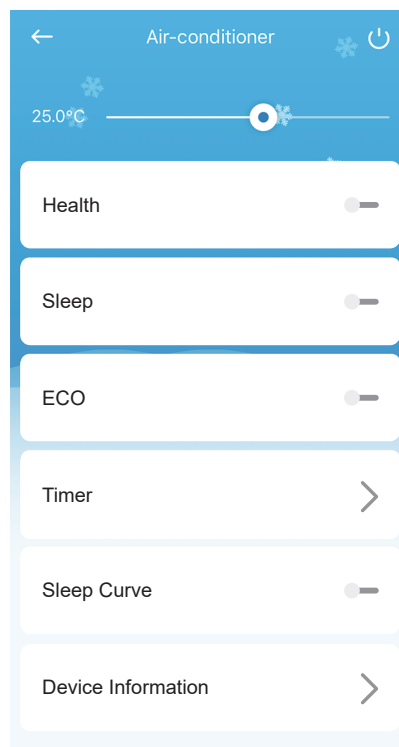

SLEEP

For Cooling: Allows the set temperature to increase and decrease over a 10 hour period at pre-set time intervals to maintain your comfort while saving energy (see graph right).

For Heating: Allows the set temperature to decrease and increase over a 10 hour period at pre-set time intervals to maintain your comfort while saving energy (see graph right).

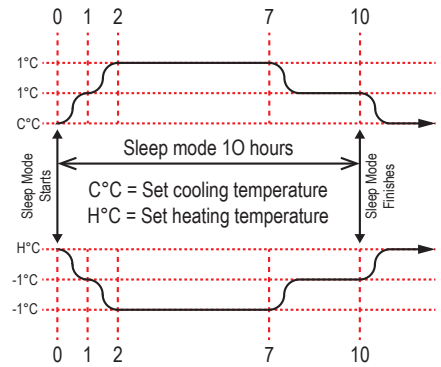

Sleep mode is not available in FAN only mode.

The Delay Off Timer can be used in conjunction with SLEEP mode to turn off the Air Conditioner automatically.

TIMER

Creating a Customised Timer:

To add a new delay timer, select the **+** sign at the top right of the Timer list page to open the Add Timer page.

Select and edit each function as required. Follow the screen prompts for desired time, repeat etc. Don't forget to **SAVE** after timer parameters have been selected.

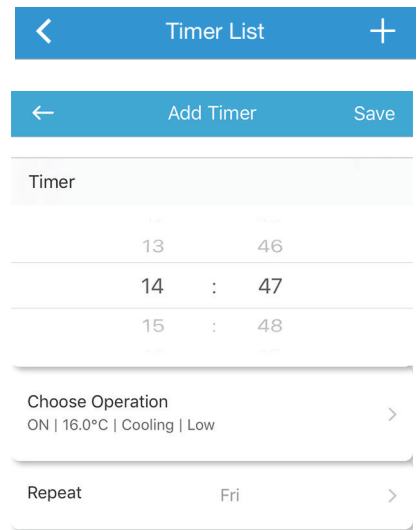
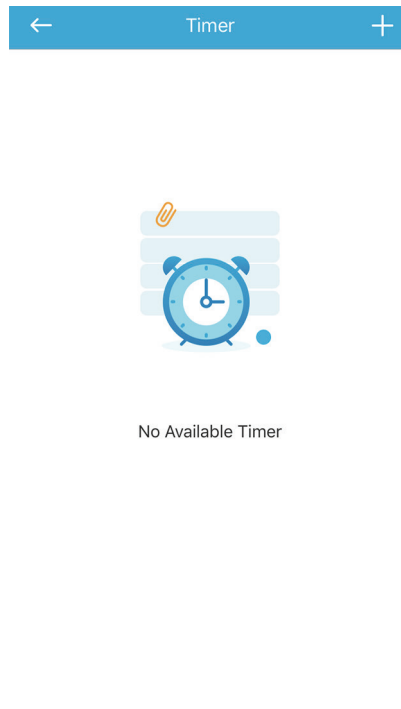

SLEEP CURVE

This is a user definable version of the Sleep function, allowing the user to create a customised sleep curve.



Only one sleep curve program can be saved at any time. It is important to note that if the power supply to the Air Conditioner is interrupted or turned off then the settings for the saved sleep curve will be lost and will need to be re-entered.

Pages with a Save option will require saving before exiting. Exiting such a page without saving will result in the loss of any unsaved edits.

< Sleep Curve Save

Sleep Time 8h >

Mode Cooling >

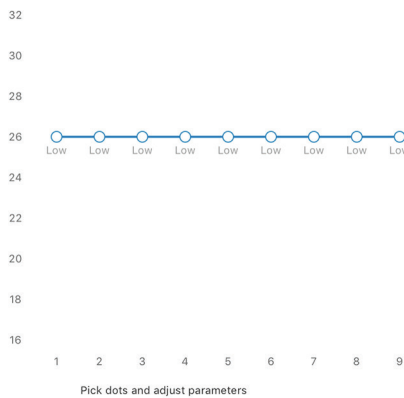

APP SETTINGS

Direct access to the previously described AC Device related pages **Add Device** and **Device List**, is provided, while the third option **Setting** enables access to additional App and AC device related settings.

A set of more advanced control operations are also available. To open the advanced operation tab, swipe the basic tab to the left. To exit the advanced operation tab and return to the basic operation page swipe the advanced operation tab to the right.

Selecting the horizontal **three dots** at the top right on the relevant pages opens the advanced App setting dialogue box.

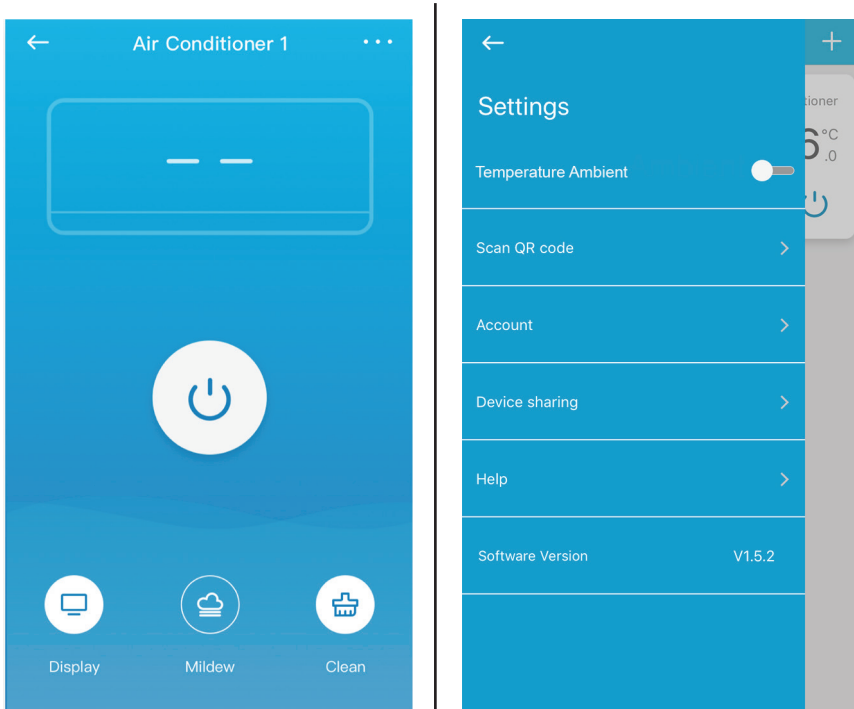

TEMPERATURE AMBIENT

This toggle shows or hides the current room temperature display.

SCAN QR CODE

As described in "Wi-Fi Set Up" on page 6.

ACCOUNT

Manage your account.

DEVICE SHARING

You can share paired account to another users.

HELP

Shows information to help user.

SOFTWARE VERSION

Shows the latest version of the software App.



Pages with a **Save** option will require saving before exiting. Exiting such a page without saving will result in the loss of any unsaved edits.

Rinnai Australia Pty Ltd

ABN 74 005 138 769 | AU24752

100 Atlantic Drive, Keysborough, Victoria 3173
P.O. Box 460, Braeside, Victoria 3195
Tel: (03) 9271 6625
Fax: (03) 9271 6622

National Help Line

Tel: 1300 555 545* Fax: 1300 555 655
Monday to Friday, 8.00 am to 5.00 pm EST.

**Cost of a local call higher from mobile or public phones.*

For further information visit www.rinnai.com.au
or email enquiry@rinnai.com.au

Rinnai has a Service and Spare Parts network with personnel who are fully trained and equipped to give the best service on your Rinnai appliance. If your appliance requires service, please call our National Help Line.

With our policy of continuous improvement, we reserve the right to change, or discontinue at any time, specifications or designs without notice.